

T03

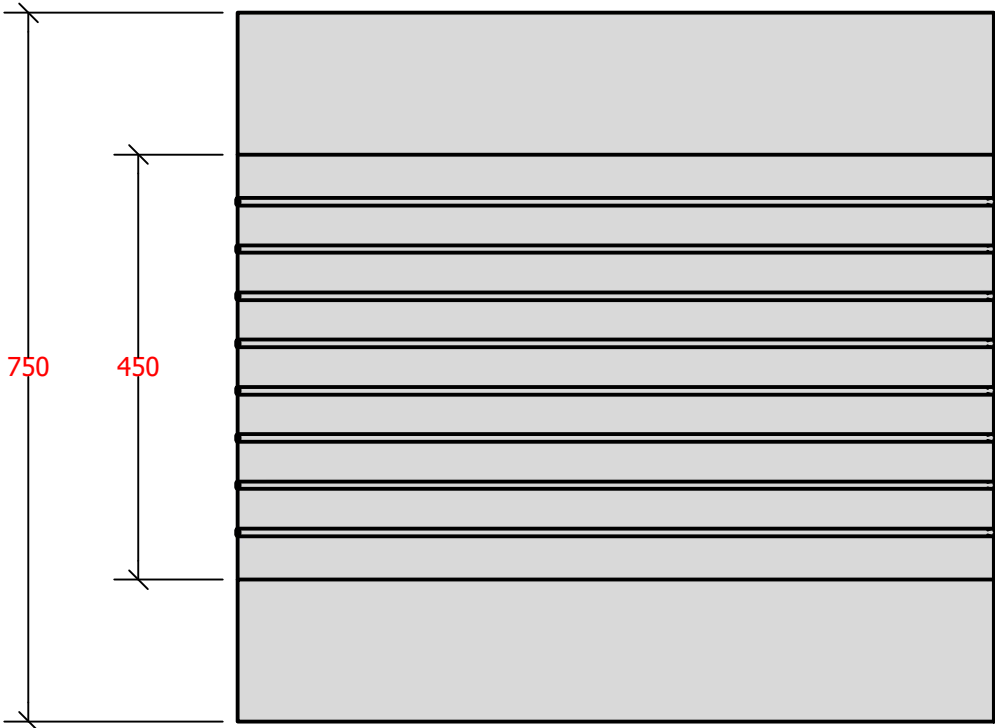
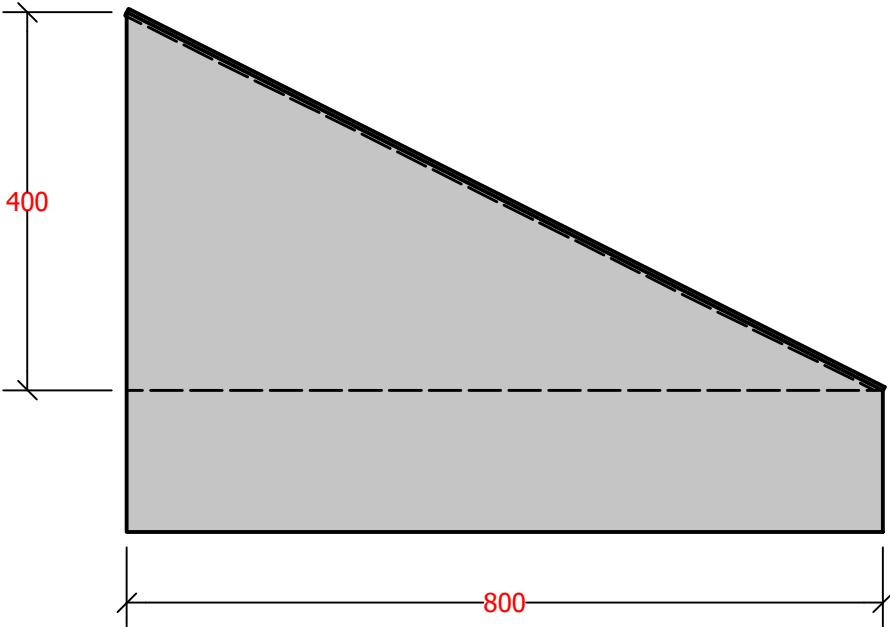

poids fond : 0T350

VISA "BON POUR ACCORD"
AVANT MISE EN FABRICATION

N° COMMANDE



CLIENT: EUROVIA	CHANTIER: JARDIN DE L'ARS -33- BORDEAUX
BETON TYPE: BPS C30/37 X52 D10	CREE PAR B. NEAU
ENROBAGE: 30mm	DATES: 22/06/2021
DIMENTION +- 20mm	Manutention : ARTEON 5T (qté: 4)



T04

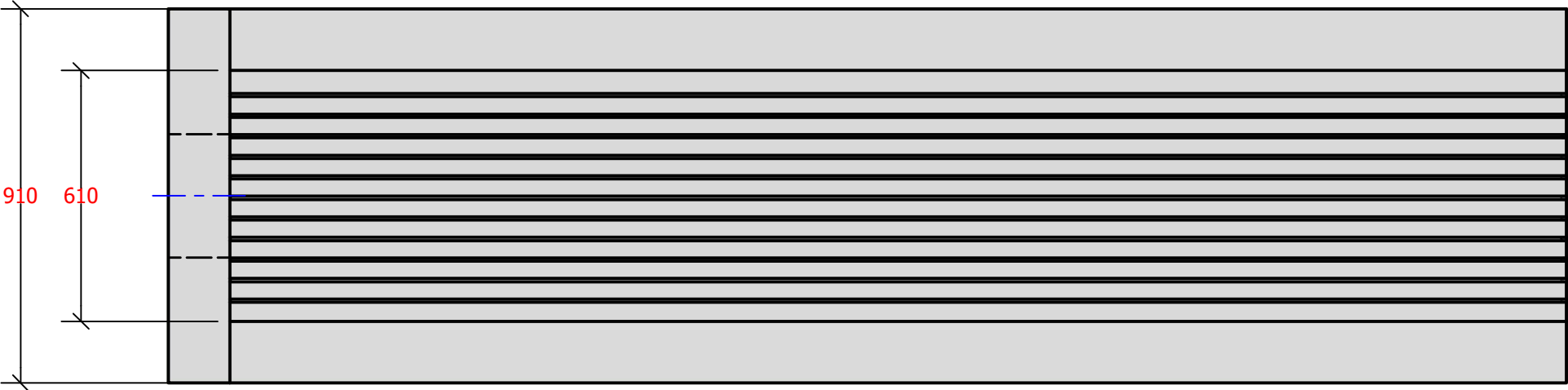
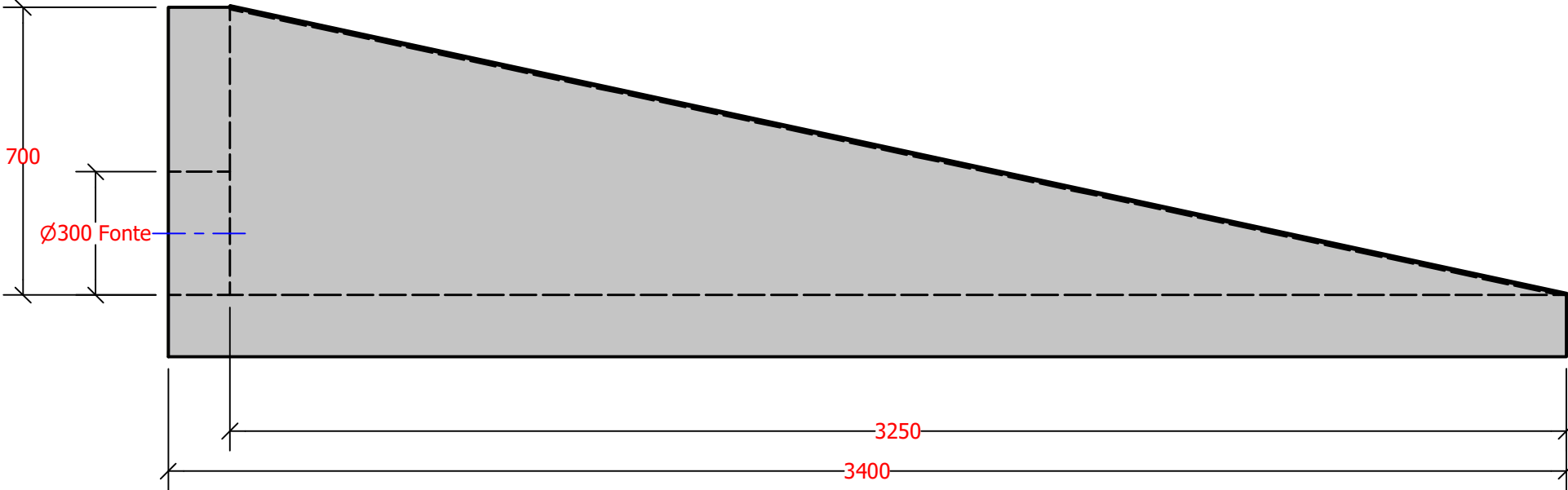
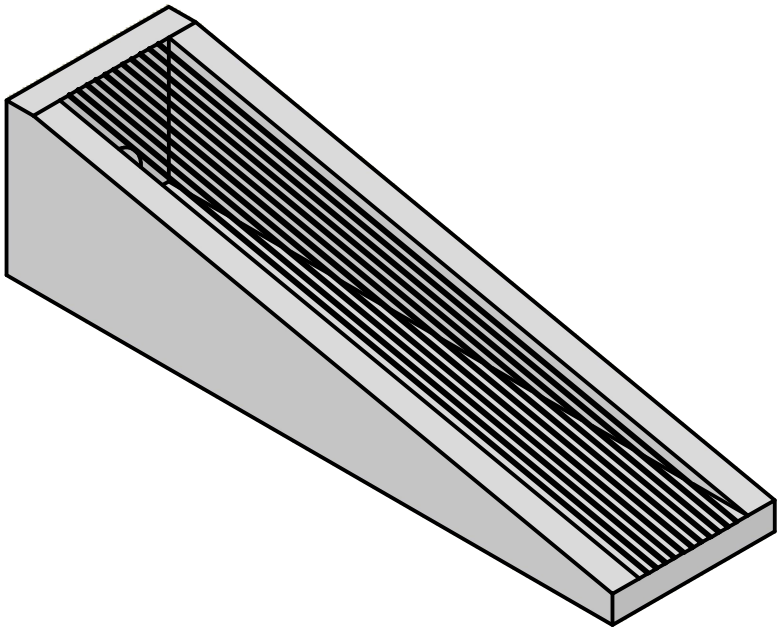

poids fond : 2T150

VISA "BON POUR ACCORD"
AVANT MISE EN FABRICATION

N° COMMANDE



CLIENT:	EUROVIA	CHANTIER:	JARDIN DE L'ARS -33- BORDEAUX
BETON TYPE:	BPS C30/37 X52 D10	CREE PAR	B. NEAU
ENROBAGE:	30mm	DATES:	22/06/2021
DIMENTION + -	20mm	Manutention :	ARTEON 5T (qté: 4)



T05

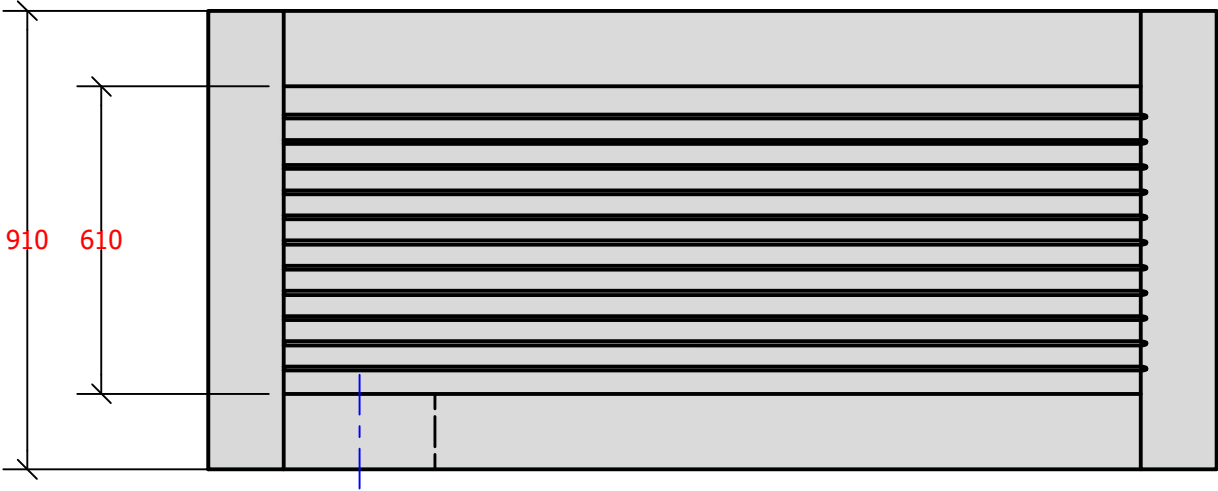
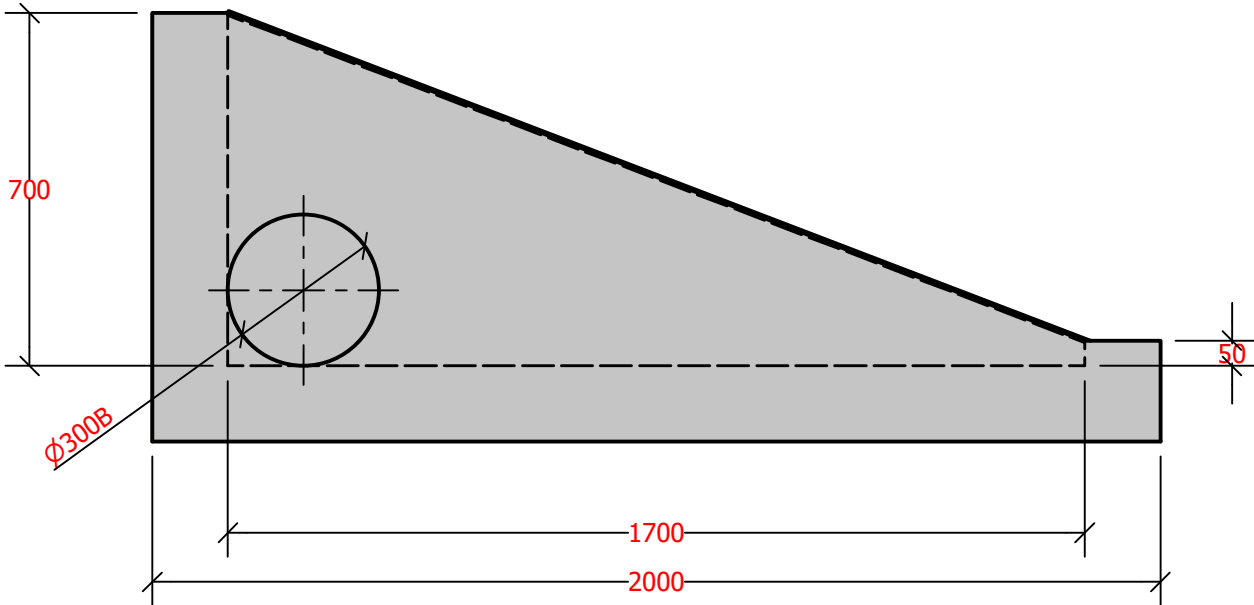
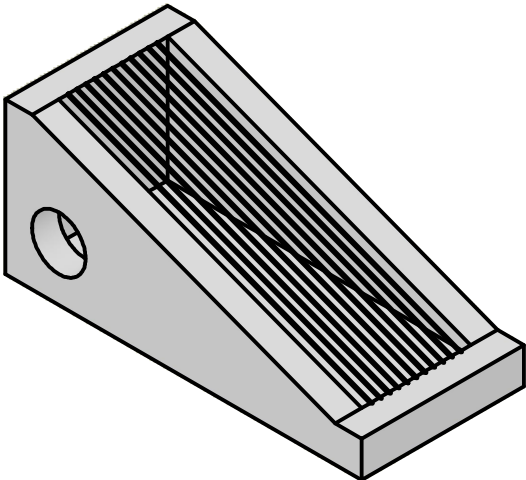

poids fond : 1T350

VISA "BON POUR ACCORD"
AVANT MISE EN FABRICATION

N° COMMANDE



CLIENT:	EUROVIA	CHANTIER: JARDIN DE L'ARS -33- BORDEAUX
BETON TYPE: BPS C30/37 X52 D10	CREE PAR B. NEAU	
ENROBAGE: 30mm	DATES:	22/06/2021
DIMENTION +- 20mm	Manutention :	ARTEON 5T (qté: 4)



T06

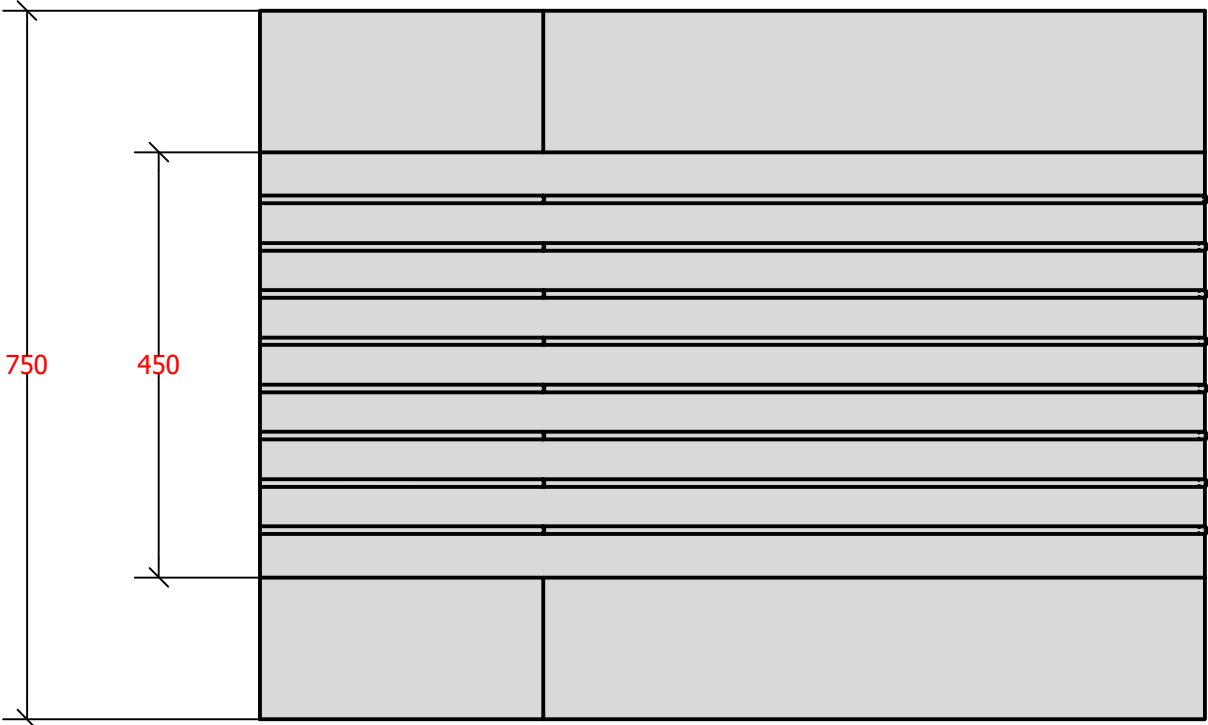
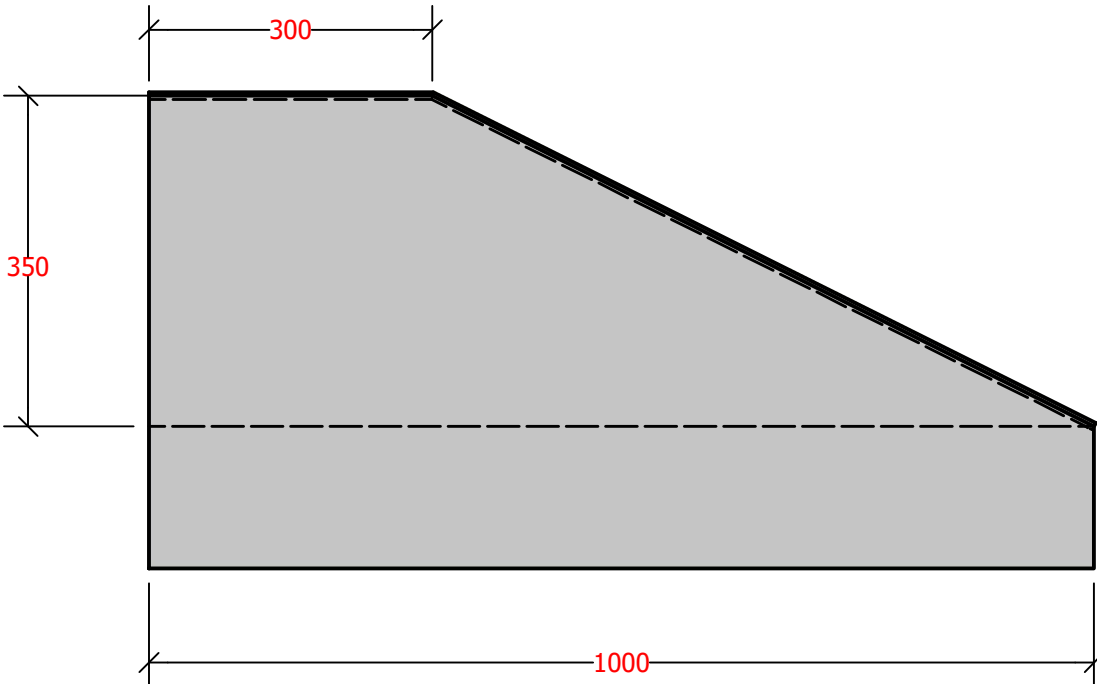
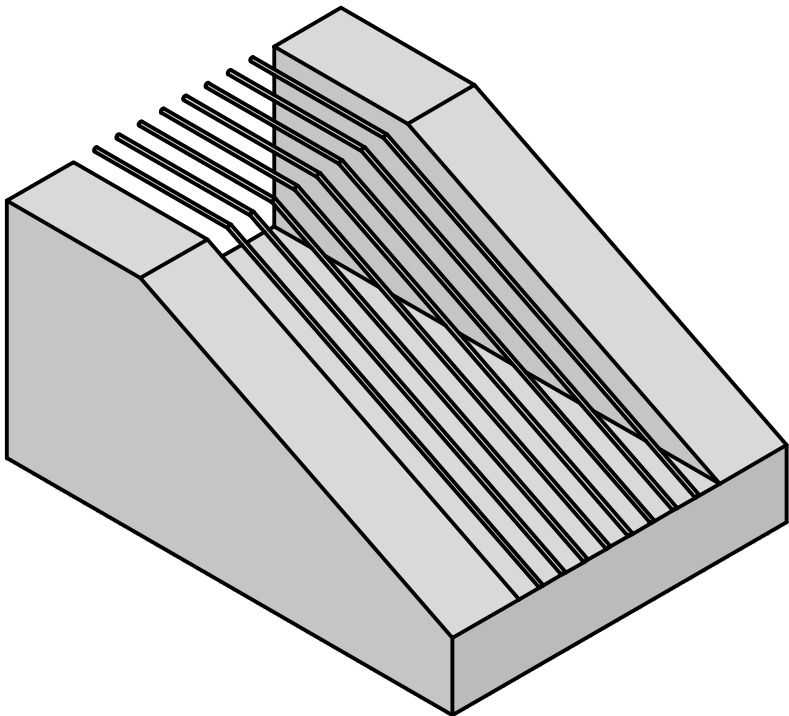

poids fond : 0T450

VISA "BON POUR ACCORD"
AVANT MISE EN FABRICATION

N° COMMANDE

CLIENT:	EUROVIA	CHANTIER: JARDIN DE L'ARS -33- BORDEAUX
BETON TYPE: BPS C30/37 XS2 D10	CREE PAR B. NEAU	VERIFIER PAR:
ENROBAGE: 30mm	DATES: 30/06/2022	REV: 1
DIMENTION +- 20mm	Manutention : ARTEON 5T (qté: 4)	



T07

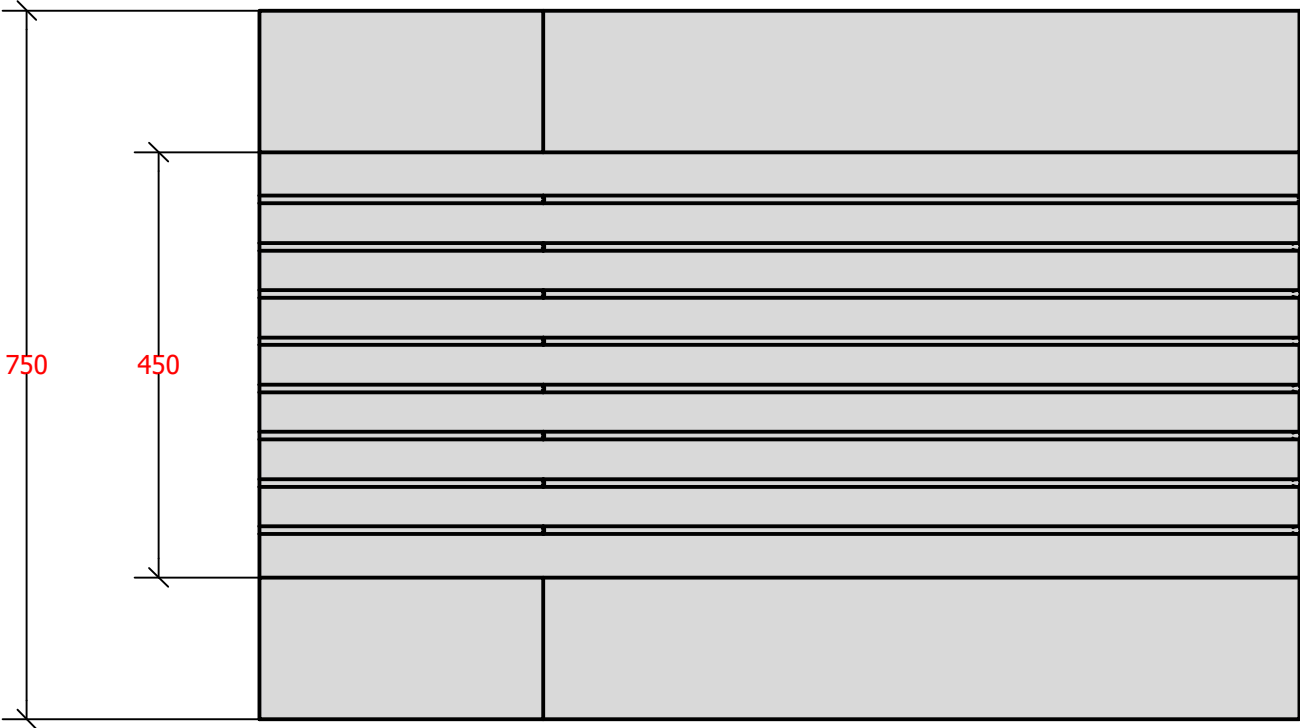
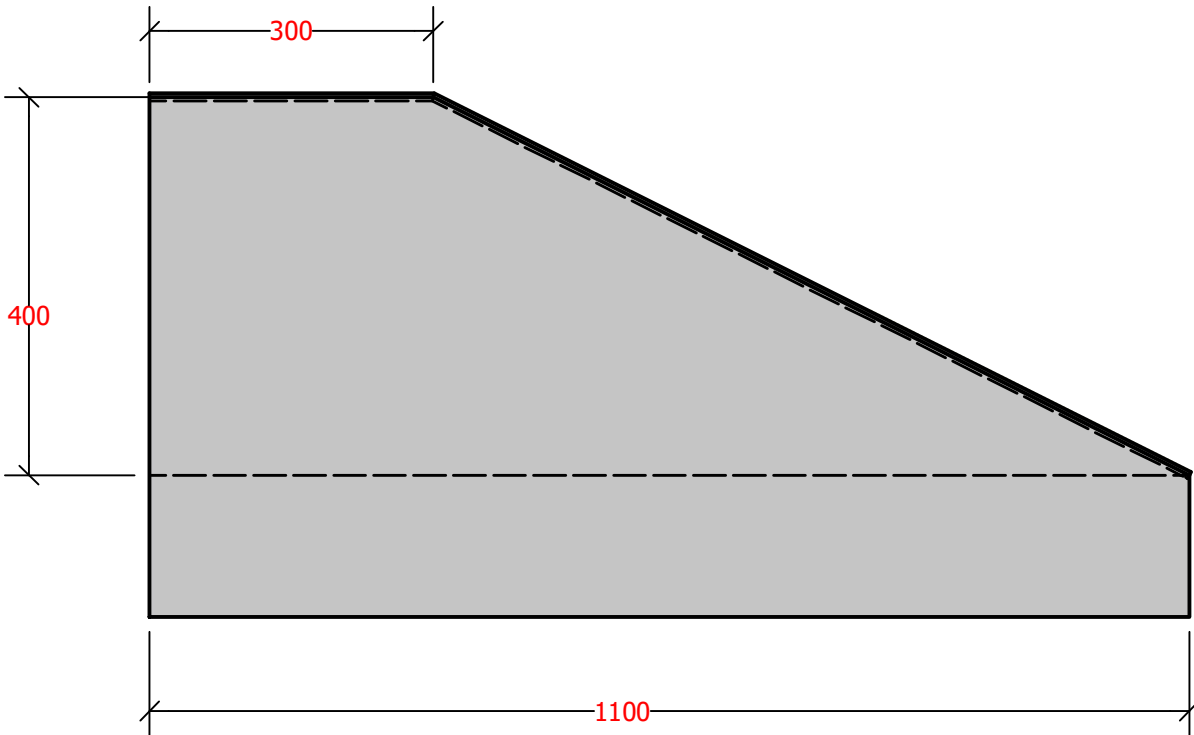
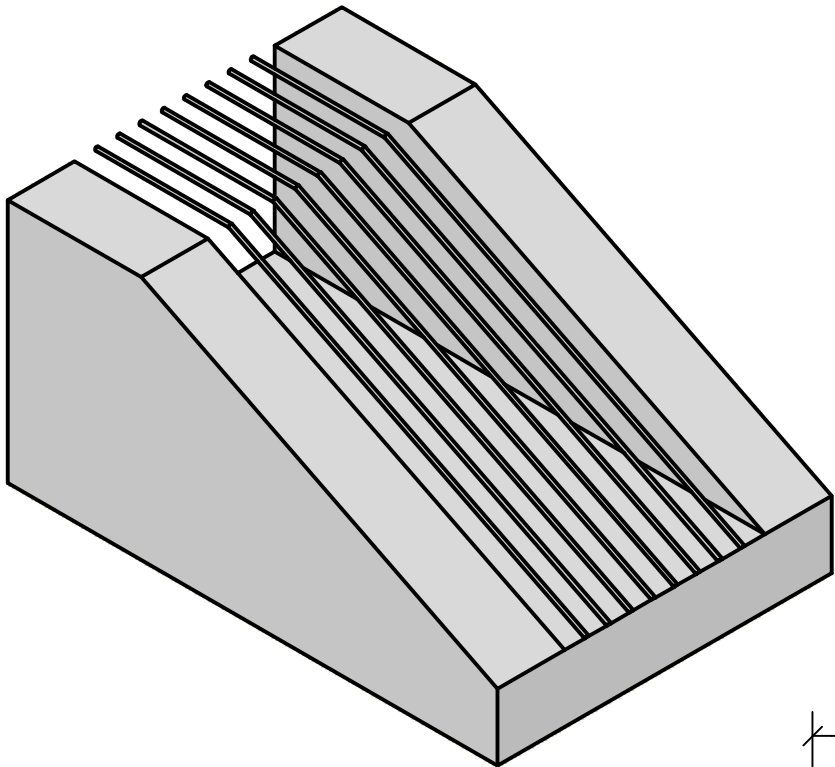

poids fond : 0T500

VISA "BON POUR ACCORD"
AVANT MISE EN FABRICATION

N° COMMANDE

CLIENT:	EUROVIA	CHANTIER: JARDIN DE L'ARS -33- BORDEAUX
BETON TYPE: BPS C30/37 XS2 D10	CREE PAR B. NEAU	VERIFIER PAR:
ENROBAGE: 30mm	DATES: 30/06/2022	REV: 1
DIMENTION +- 20mm	Manutention : ARTEON 5T (qté: 4)	



T10

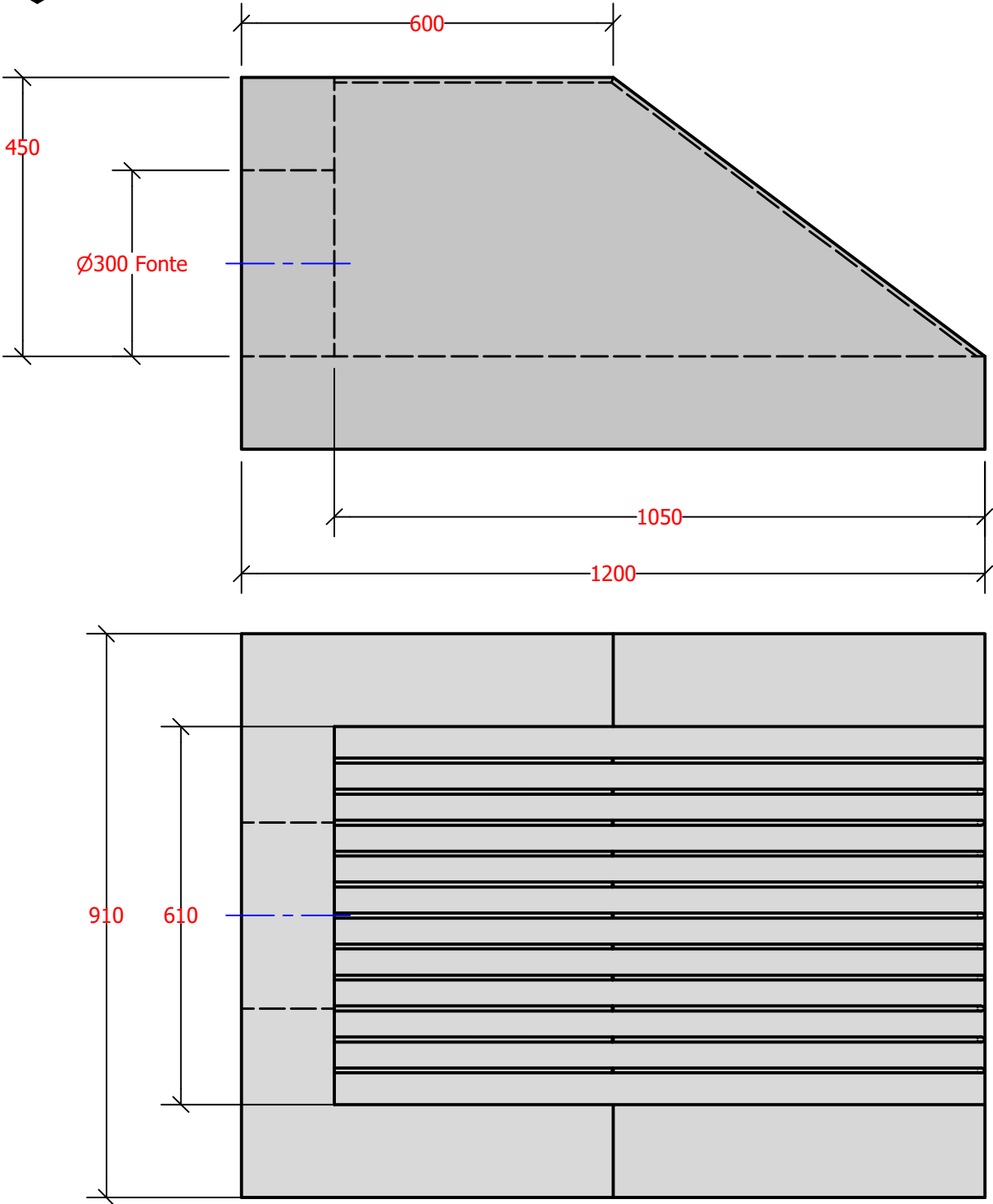
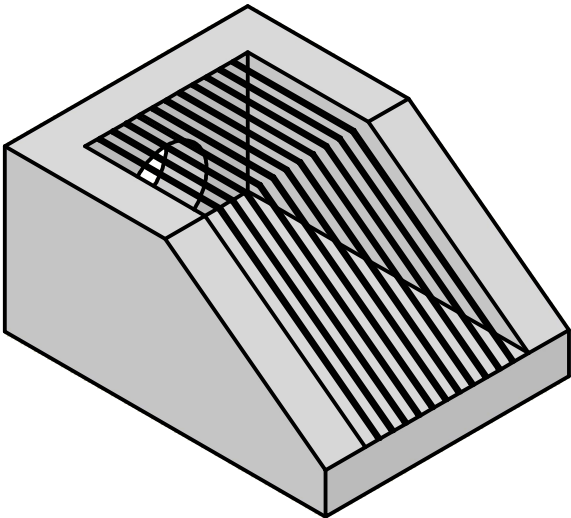

poids fond : T800

VISA "BON POUR ACCORD"
AVANT MISE EN FABRICATION

N° COMMANDE



CLIENT:	EUROVIA	CHANTIER: JARDIN DE L'ARS -33- BORDEAUX
BETON TYPE: BPS C30/37 X52 D10	CREE PAR B. NEAU	
ENROBAGE: 30mm	DATES:	22/06/2021
DIMENTION +- 20mm	Manutention :	ARTEON 5T (qté: 4)



T11

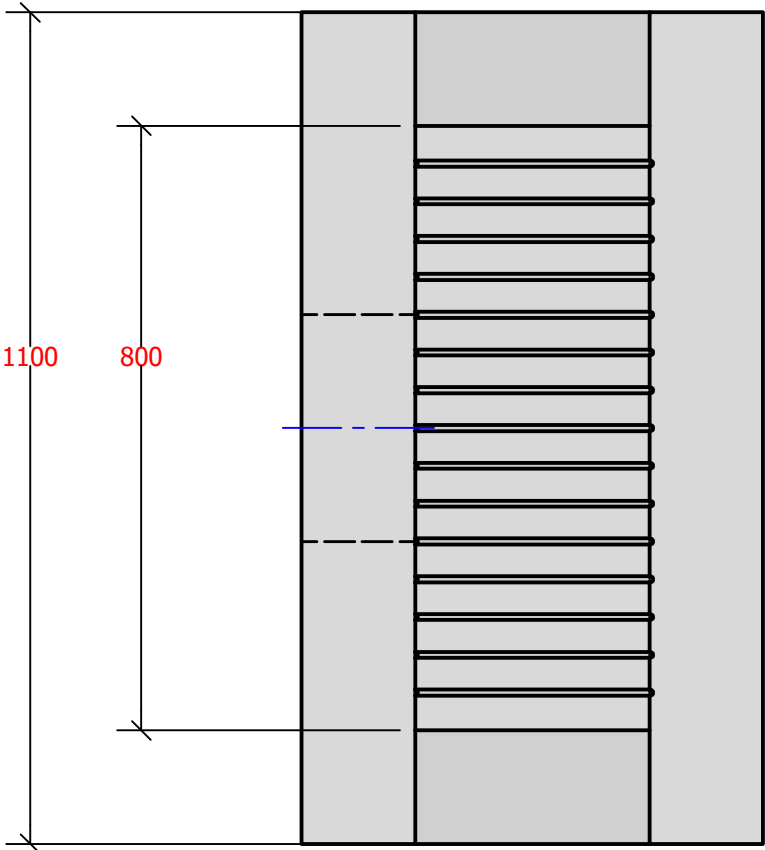
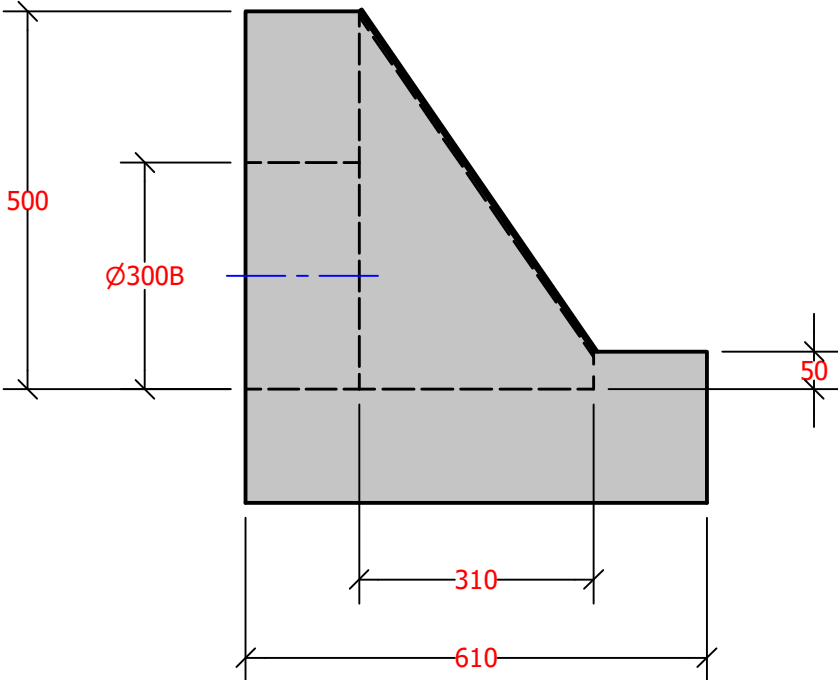
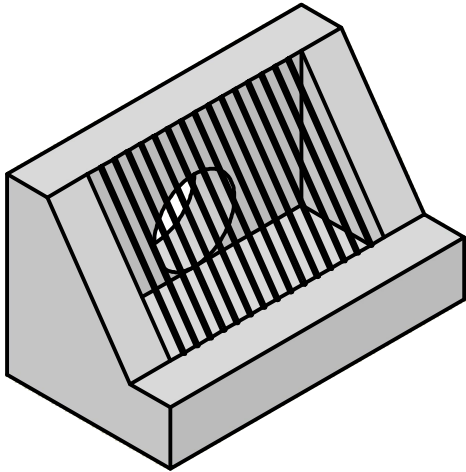

poids fond : 0T500

VISA "BON POUR ACCORD"
AVANT MISE EN FABRICATION

N° COMMANDE



Usine de Luçon
Usine de STE Florence
Usine de Chenon
Hors BPE Chenon



Usine de Luçon

CLIENT: EUROVIA	CHANTIER: JARDIN DE L'ARS -33- BORDEAUX
BETON TYPE: BPS C30/37 X52 D10	CREE PAR B. NEAU
ENROBAGE: 30mm	DATES: 22/06/2021
DIMENTION +- 20mm	Manutention : ARTEON 5T (qté: 4)



T14

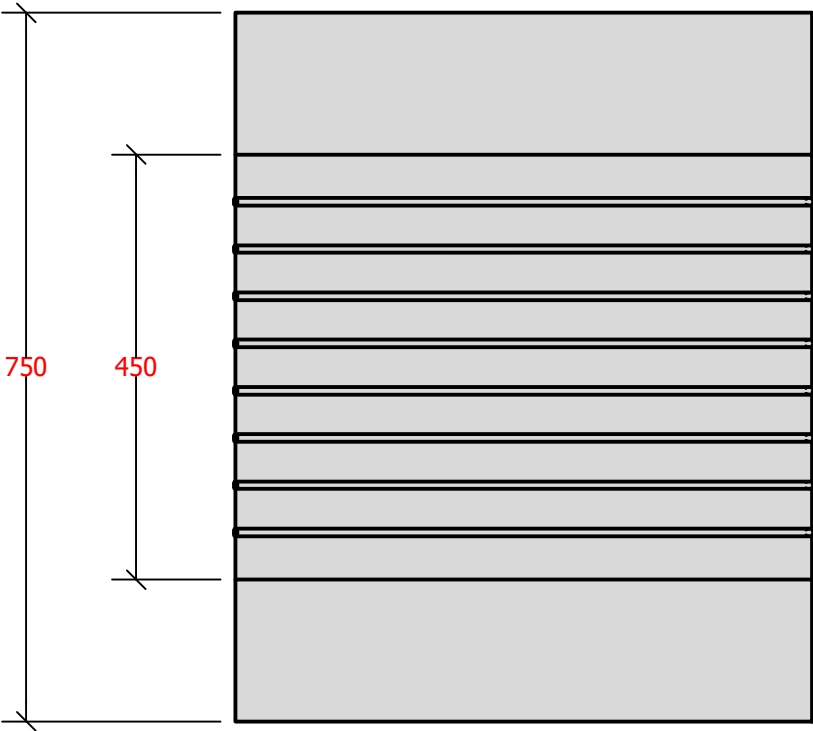
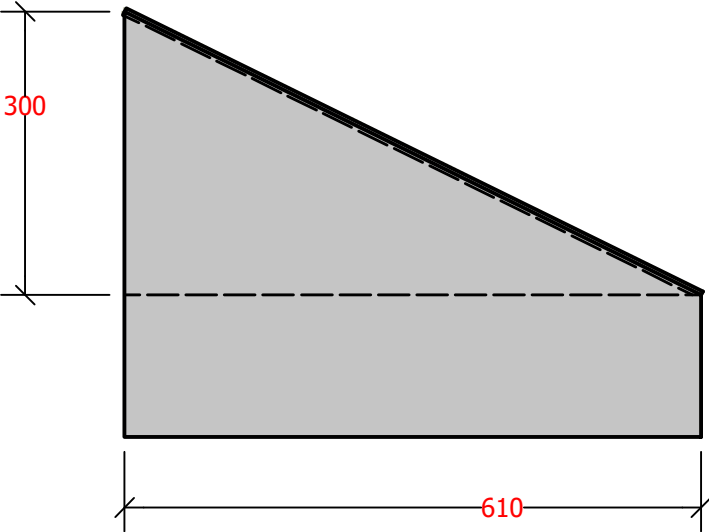
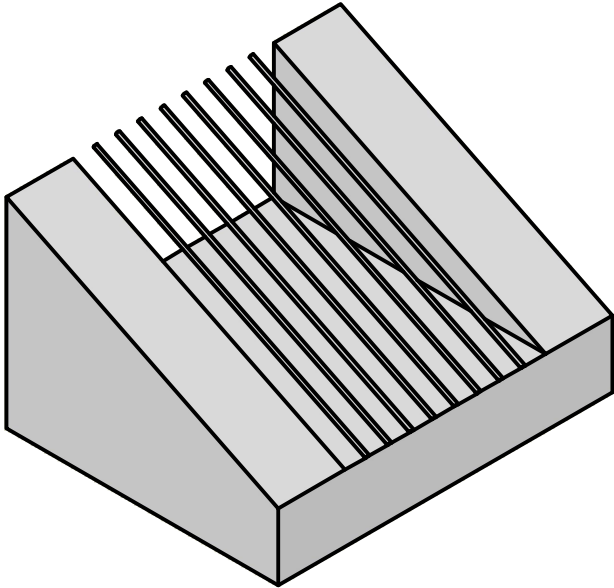

poids fond : 0T250

VISA "BON POUR ACCORD"
AVANT MISE EN FABRICATION

N° COMMANDE



Usine de Luçon
Usine de STE Florence
Usine de Chenon
Hors BPE Chenon



Usine de Luçon

CLIENT: EUROVIA	CHANTIER: JARDIN DE L'ARS -33- BORDEAUX
BETON TYPE: BPS C30/37 X52 D10	CREE PAR B. NEAU
ENROBAGE: 30mm	DATES: 22/06/2021
DIMENTION +- 20mm	Manutention : ARTEON 5T (qté: 4)

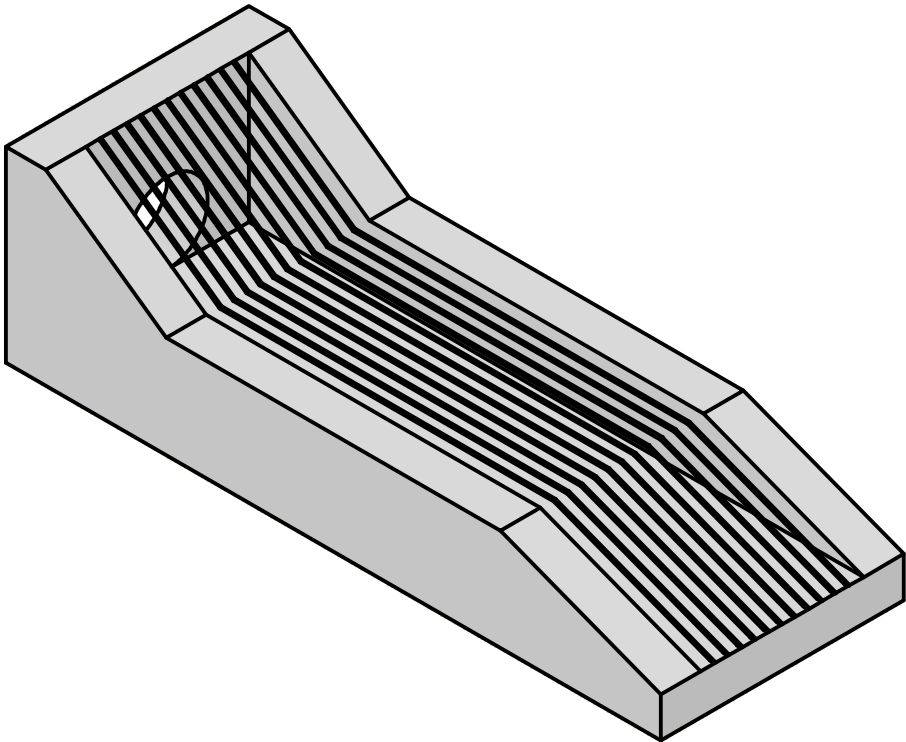

T15

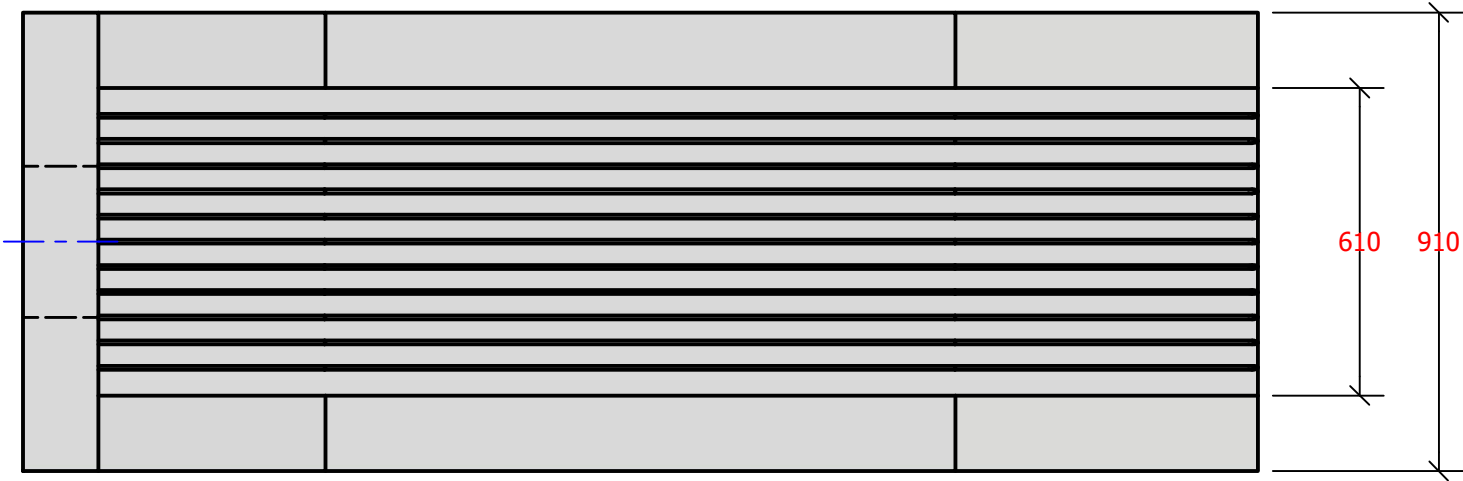
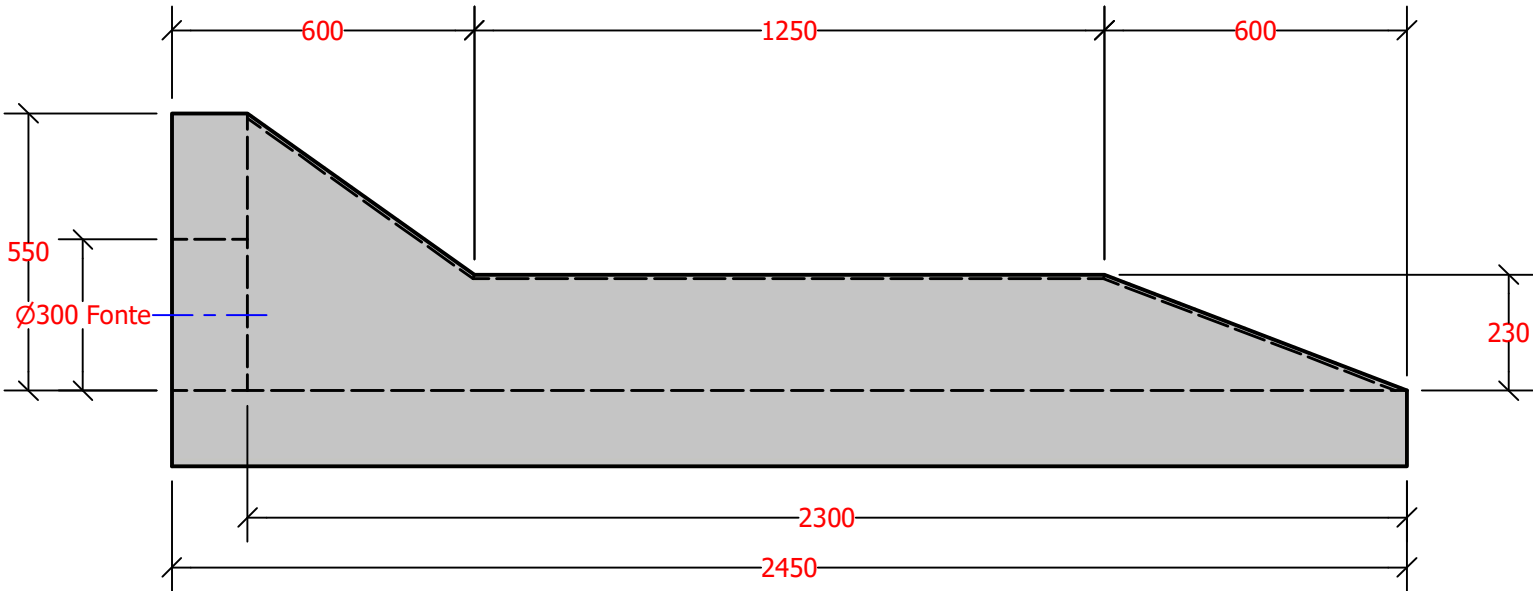

poids fond : 1T350

VISA "BON POUR ACCORD"
AVANT MISE EN FABRICATION

N° COMMANDE



CLIENT: EUROVIA	CHANTIER: JARDIN DE L'ARS -33- BORDEAUX
BETON TYPE: BPS C30/37 X52 D10	CREE PAR B. NEAU
ENROBAGE: 30mm	DATES: 23/06/2021
DIMENTION +- 20mm	Manutention : ARTEON 5T (qté: 4)

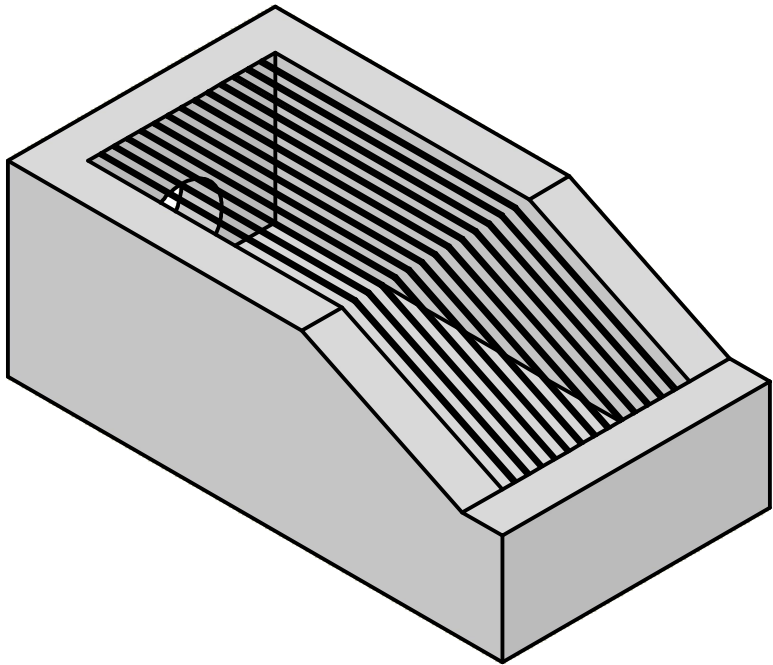

T16

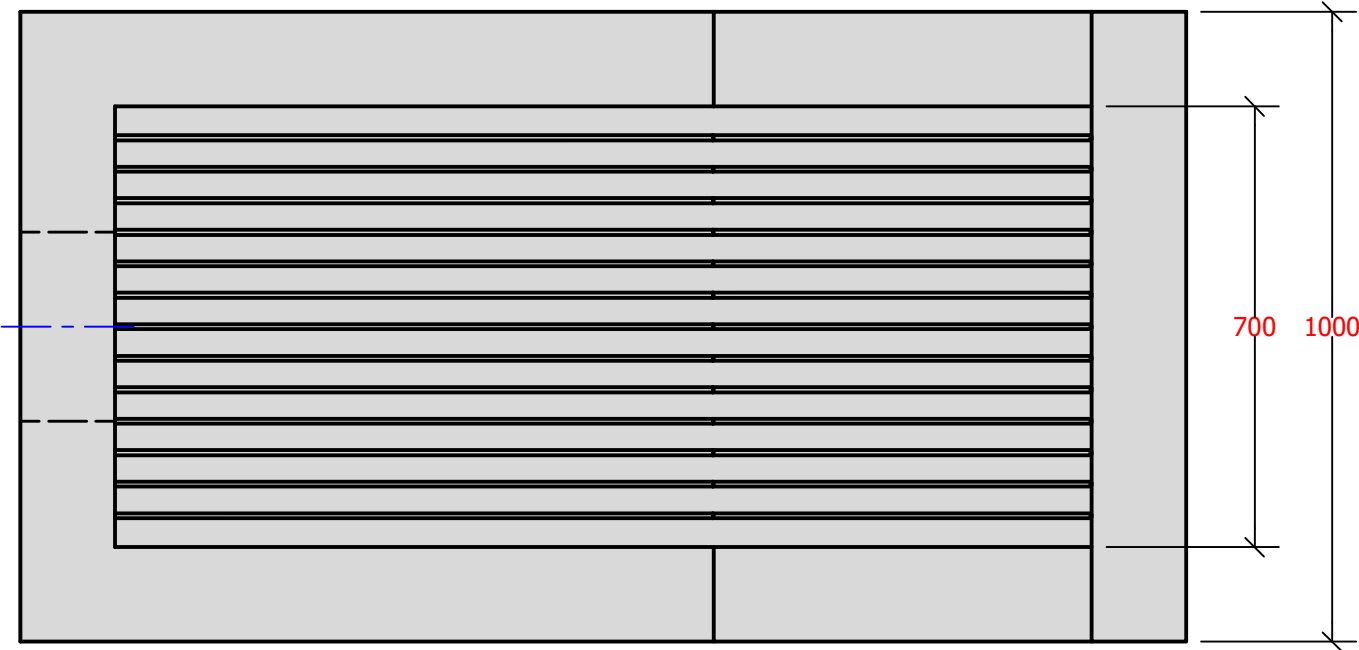
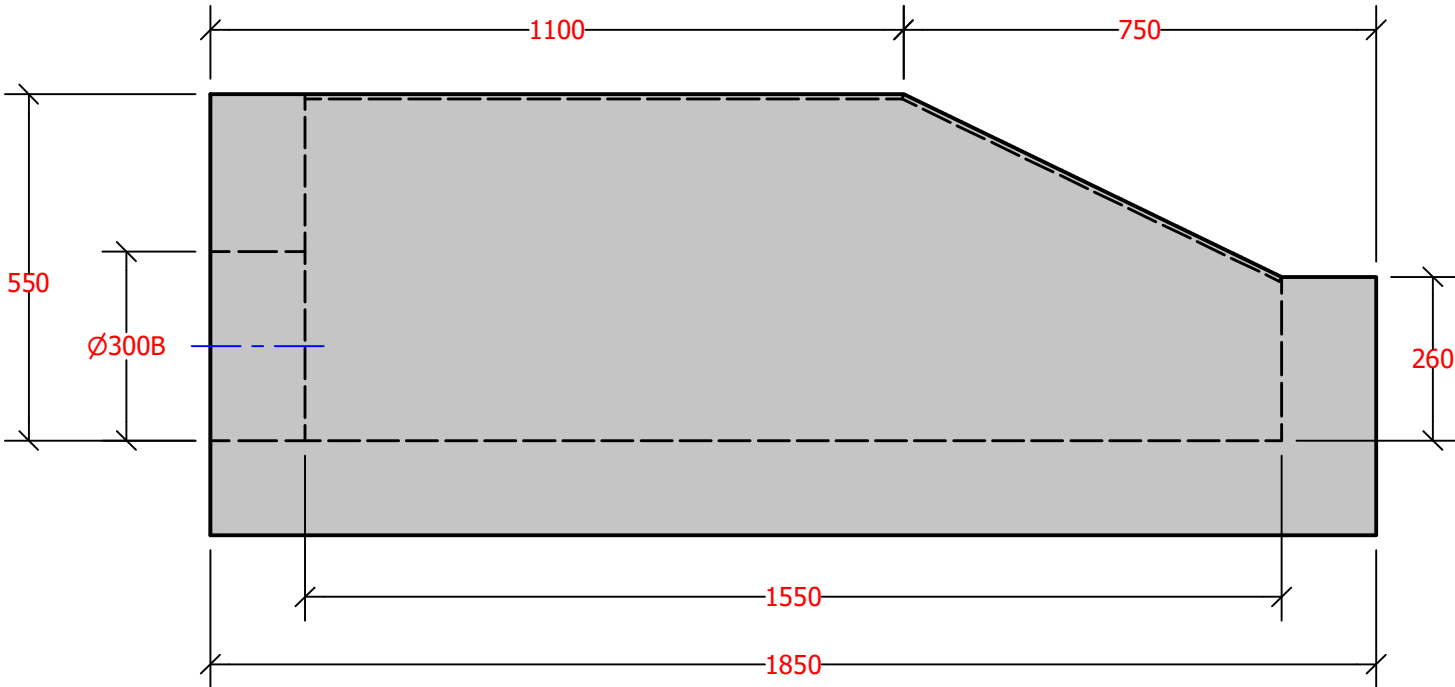

poids fond : 1T500

VISA "BON POUR ACCORD"
AVANT MISE EN FABRICATION

N° COMMANDE



CLIENT:	EUROVIA	CHANTIER: JARDIN DE L'ARS -33- BORDEAUX
BETON TYPE: BPS C30/37 X52 D10	CREE PAR B. NEAU	
ENROBAGE: 30mm	DATES:	23/06/2021
DIMENTION +- 20mm	Manutention :	ARTEON 5T (qté: 4)



T20

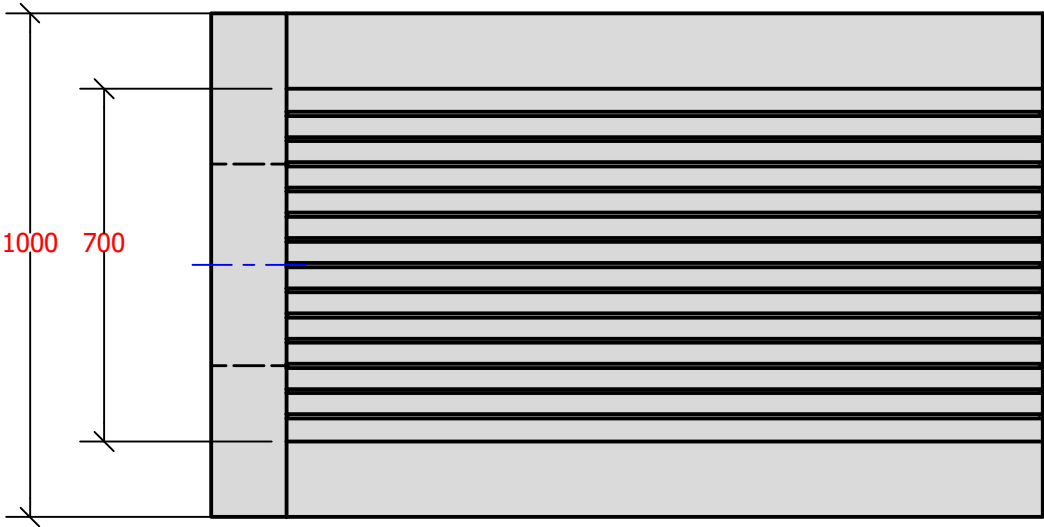
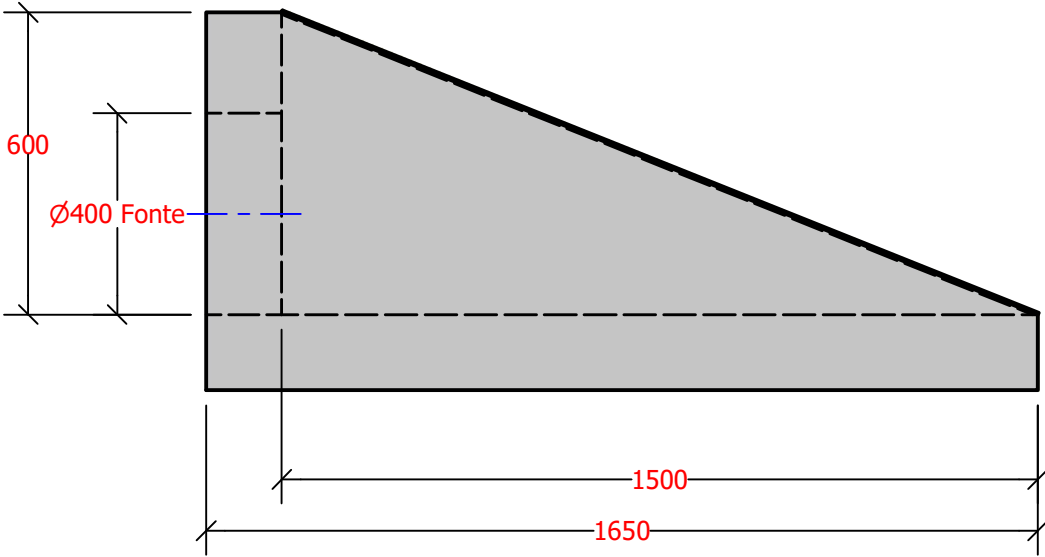
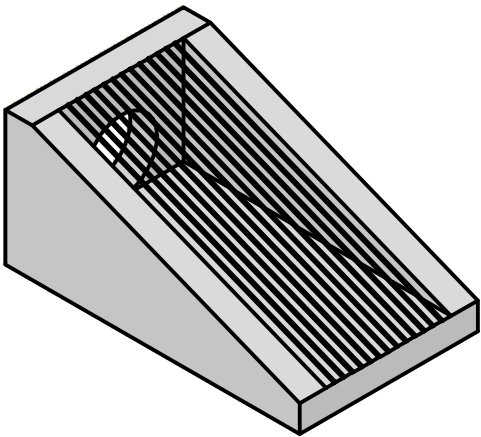

poids fond : 1T100

VISA "BON POUR ACCORD"
AVANT MISE EN FABRICATION

N° COMMANDE



CLIENT:	EUROVIA	CHANTIER: JARDIN DE L'ARS -33- BORDEAUX
BETON TYPE: BPS C30/37 X52 D10	CREE PAR B. NEAU	
ENROBAGE: 30mm	DATES:	22/06/2021
DIMENTION +- 20mm	Manutention :	ARTEON 5T (qté: 4)



T21

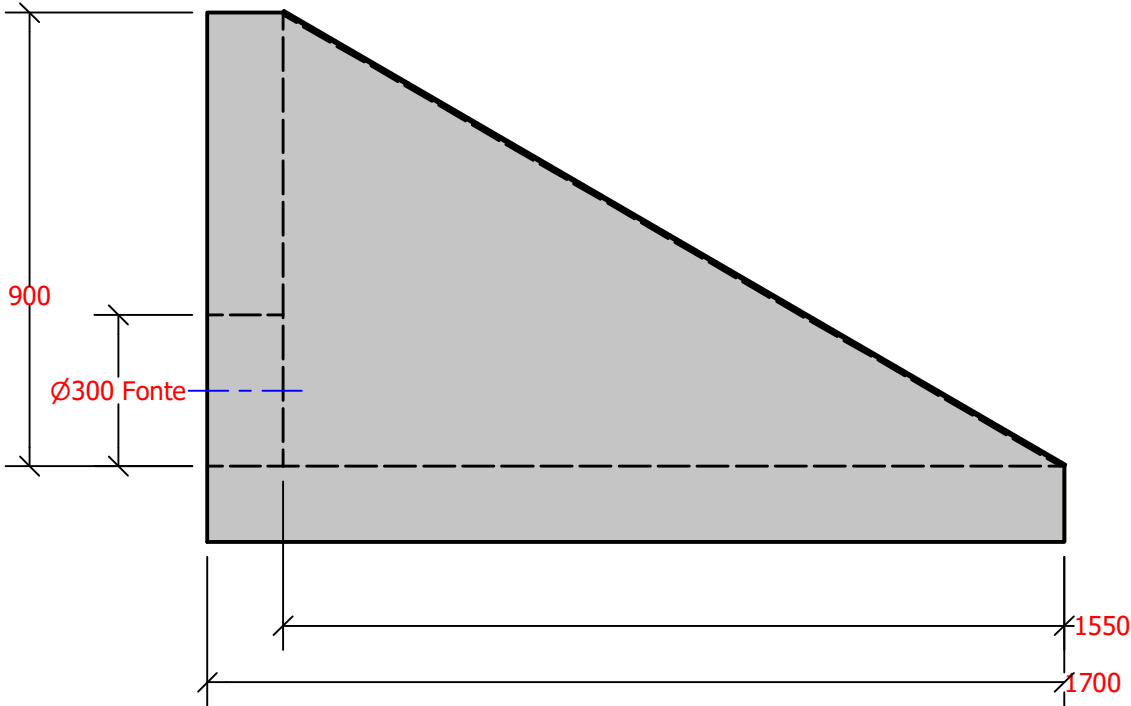
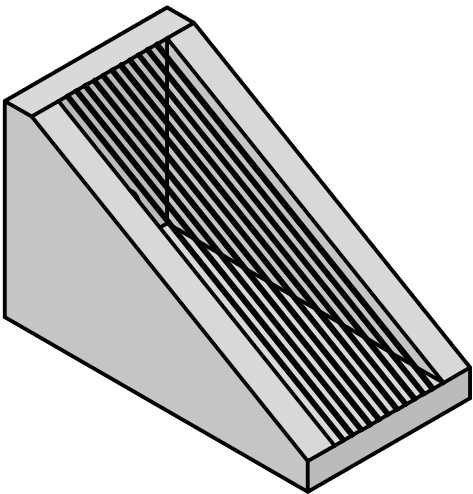

poids fond : 1T350

VISA "BON POUR ACCORD"
AVANT MISE EN FABRICATION

N° COMMANDE



CLIENT: EUROVIA	CHANTIER: JARDIN DE L'ARS -33- BORDEAUX
BETON TYPE: BPS C30/37 X52 D10	CREE PAR B. NEAU
ENROBAGE: 30mm	DATES: 22/06/2021
DIMENTION +- 20mm	Manutention : ARTEON 5T (qté: 4)



T21 Bis

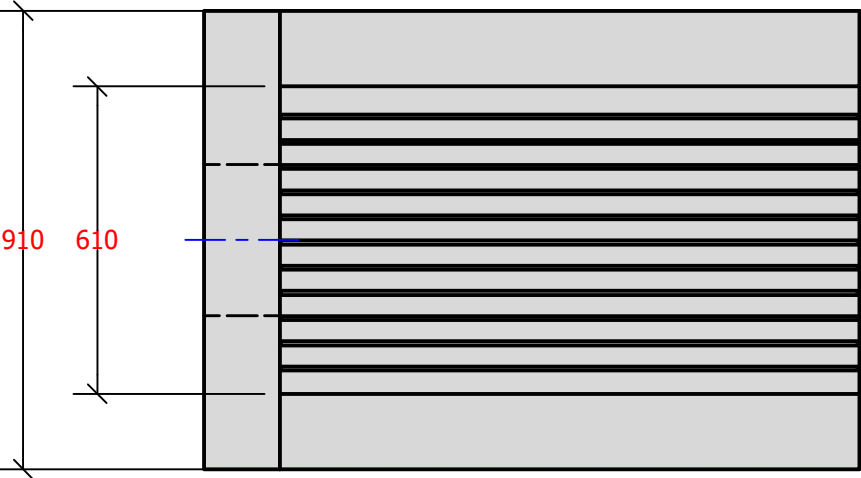
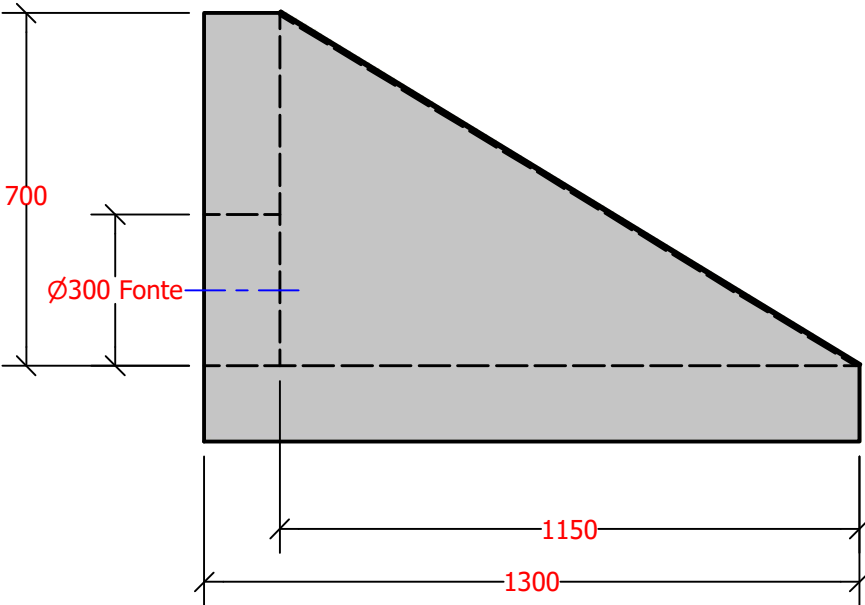
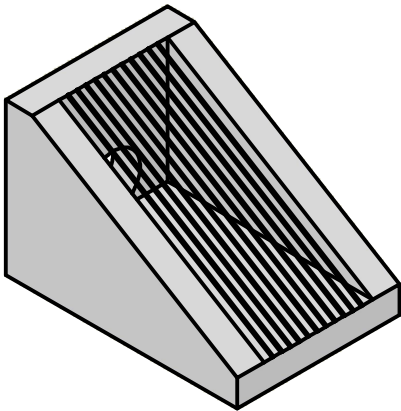

poids fond : 0T950

VISA "BON POUR ACCORD"

AVANT MISE EN FABRICATION

N° COMMANDE



CLIENT:	EUROVIA	CHANTIER: JARDIN DE L'ARS -33- BORDEAUX
BETON TYPE: BPS C30/37 X52 D10	CREE PAR B. NEAU	
ENROBAGE: 30mm	DATES:	22/06/2021
DIMENTION +- 20mm	Manutention :	ARTEON 5T (qté: 4)



T22

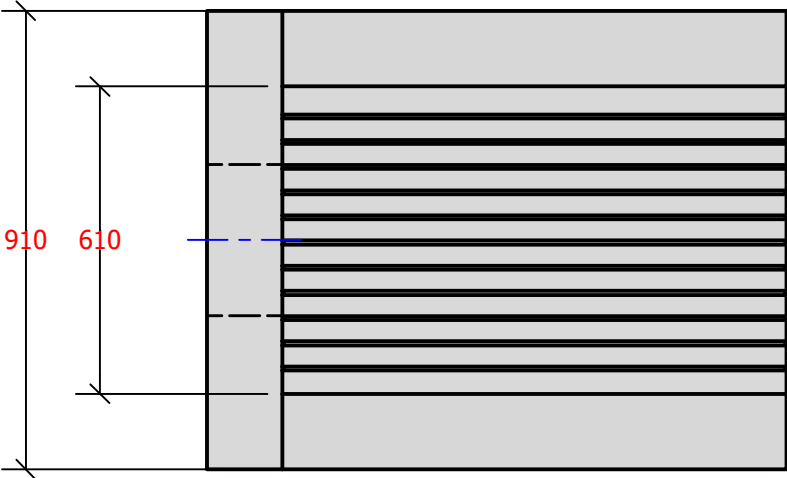
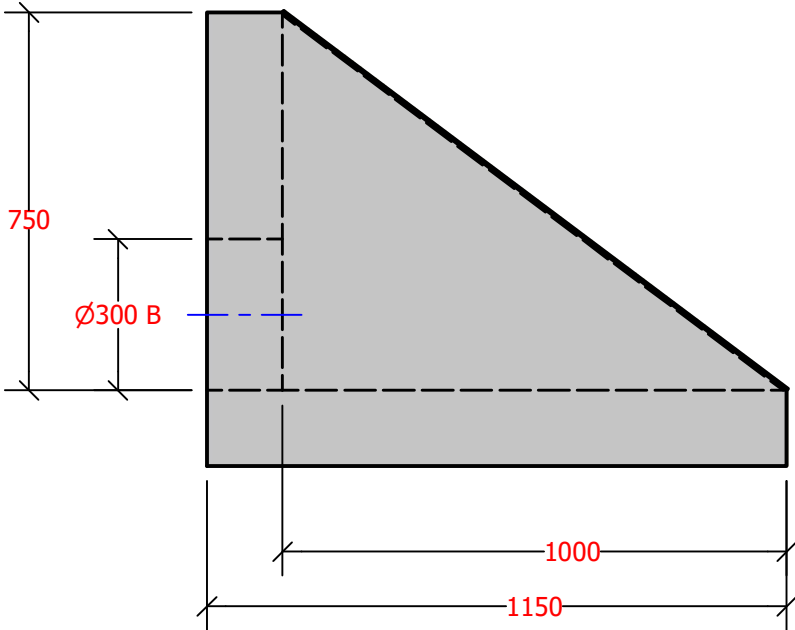
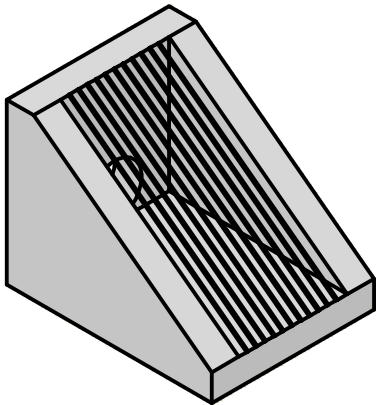

poids fond : 0T900

VISA "BON POUR ACCORD"
AVANT MISE EN FABRICATION

N° COMMANDE



CLIENT: EUROVIA	CHANTIER: JARDIN DE L'ARS -33- BORDEAUX
BETON TYPE: BPS C30/37 X52 D10	CREE PAR B. NEAU
ENROBAGE: 30mm	DATES: 22/06/2021
DIMENTION +- 20mm	Manutention : ARTEON 5T (qté: 4)



T29

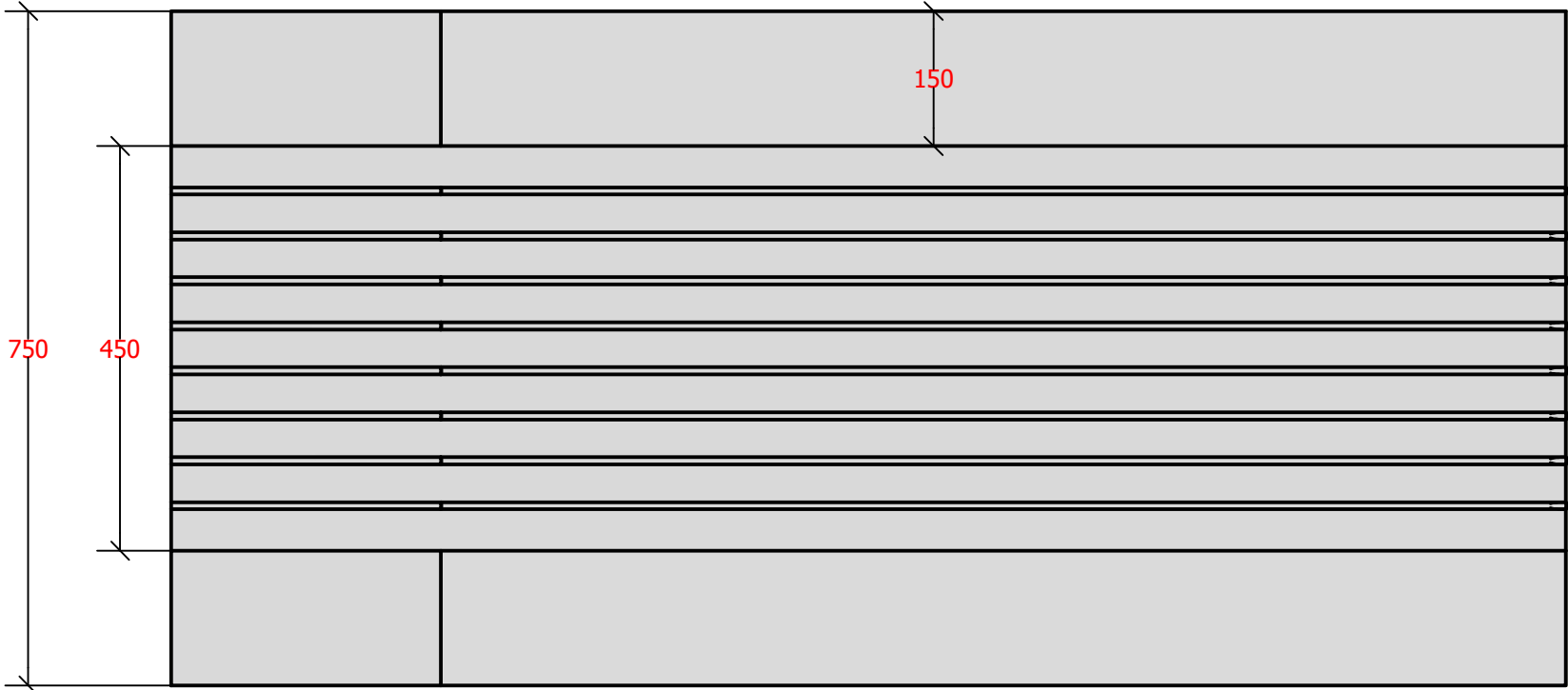
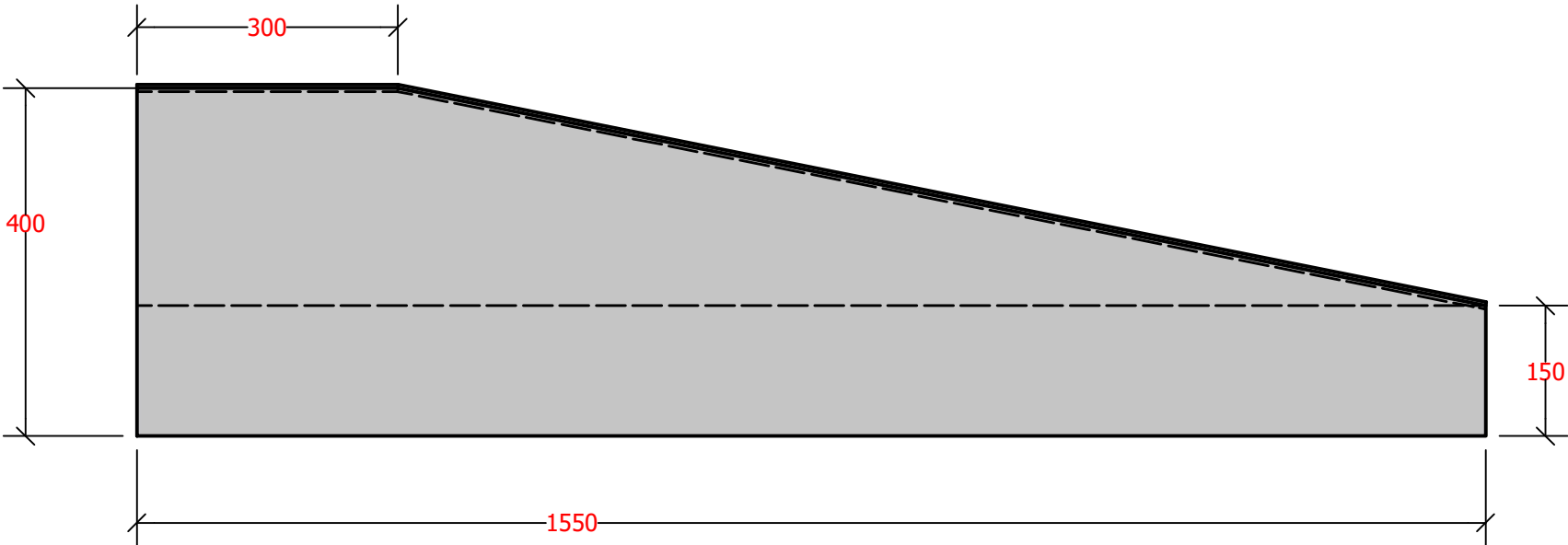
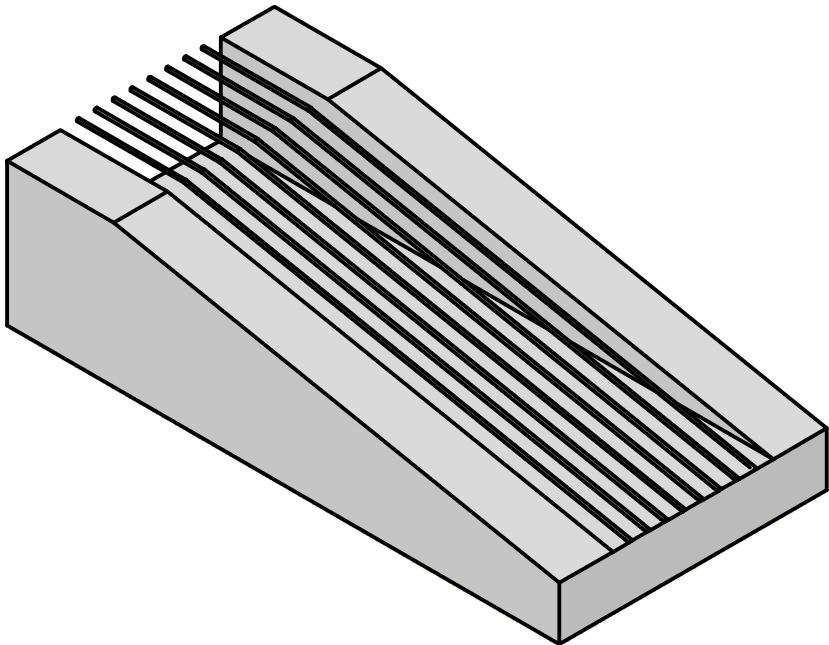

poids fond : 0T600

VISA "BON POUR ACCORD"
AVANT MISE EN FABRICATION

N° COMMANDE

CLIENT:	EUROVIA	CHANTIER: JARDIN DE L'ARS -33- BORDEAUX
BETON TYPE: BPS C30/37 XS2 D10	CREE PAR B. NEAU	VERIFIER PAR:
ENROBAGE: 30mm	DATES: 22/09/2022	REV: 1
DIMENTION +- 20mm	Manutention : ARTEON 5T (qté: 4)	
ce plan est la propriété de LIBAUD SA et ne peut être reproduit, communiqué, utilisé sans son autorisation.		

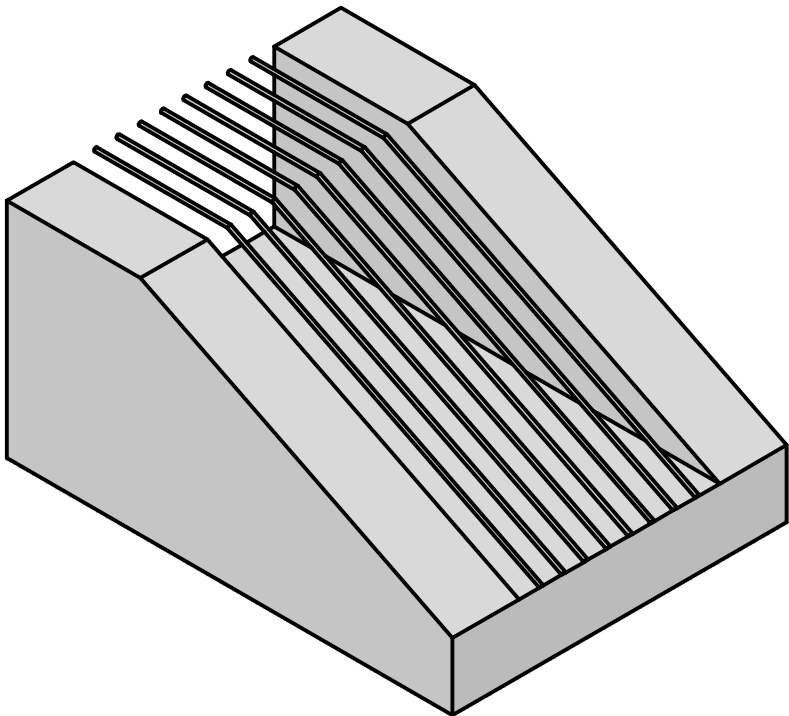

T30

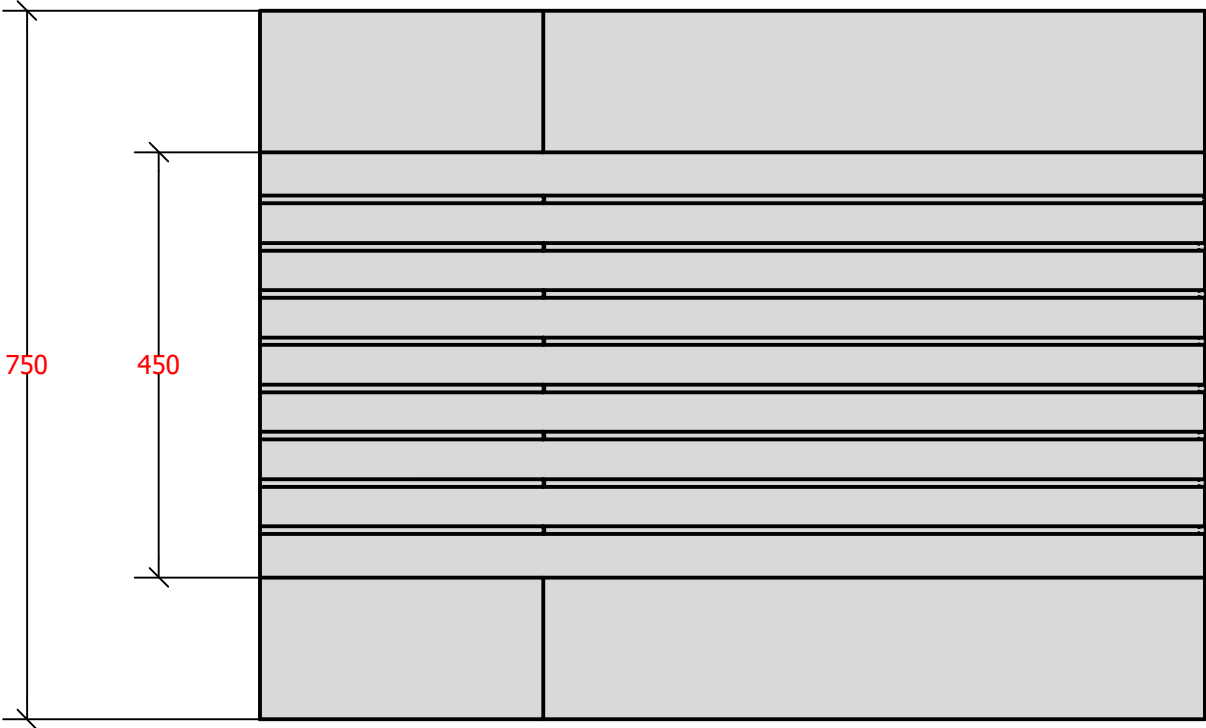
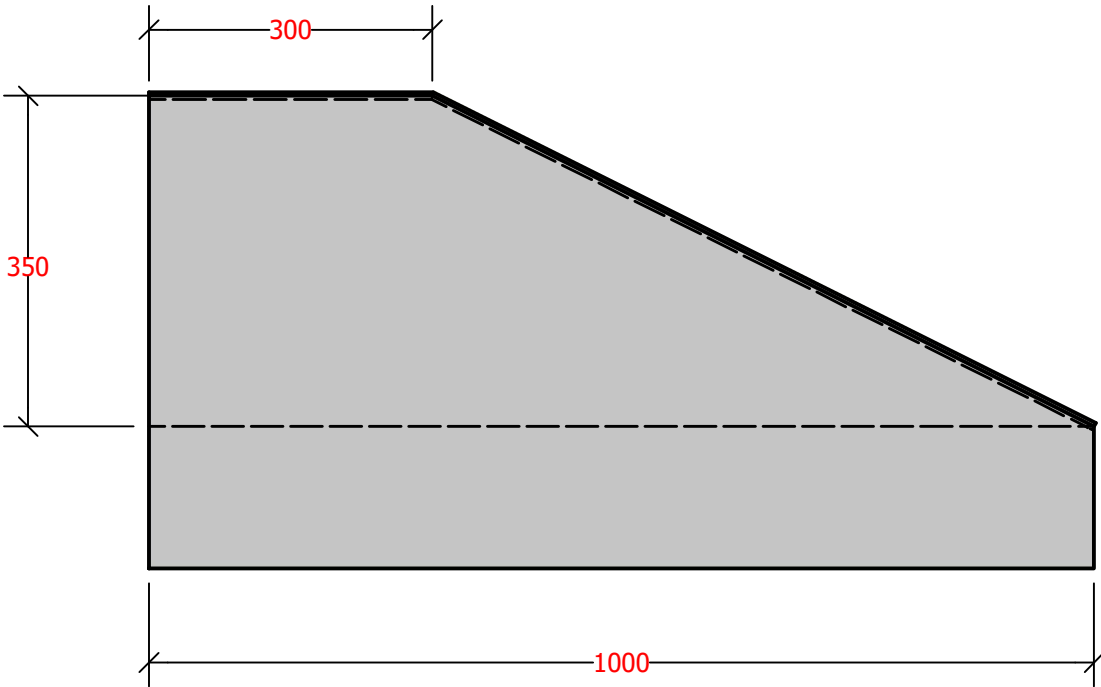

poids fond : 0T450

VISA "BON POUR ACCORD"
AVANT MISE EN FABRICATION

N° COMMANDE

CLIENT:	EUROVIA	CHANTIER: JARDIN DE L'ARS -33- BORDEAUX
BETON TYPE: BPS C30/37 XS2 D10	CREE PAR B. NEAU	VERIFIER PAR:
ENROBAGE: 30mm	DATES: 30/06/2022	REV: 1
DIMENTION +- 20mm	Manutention : ARTEON 5T (qté: 4)	



T31

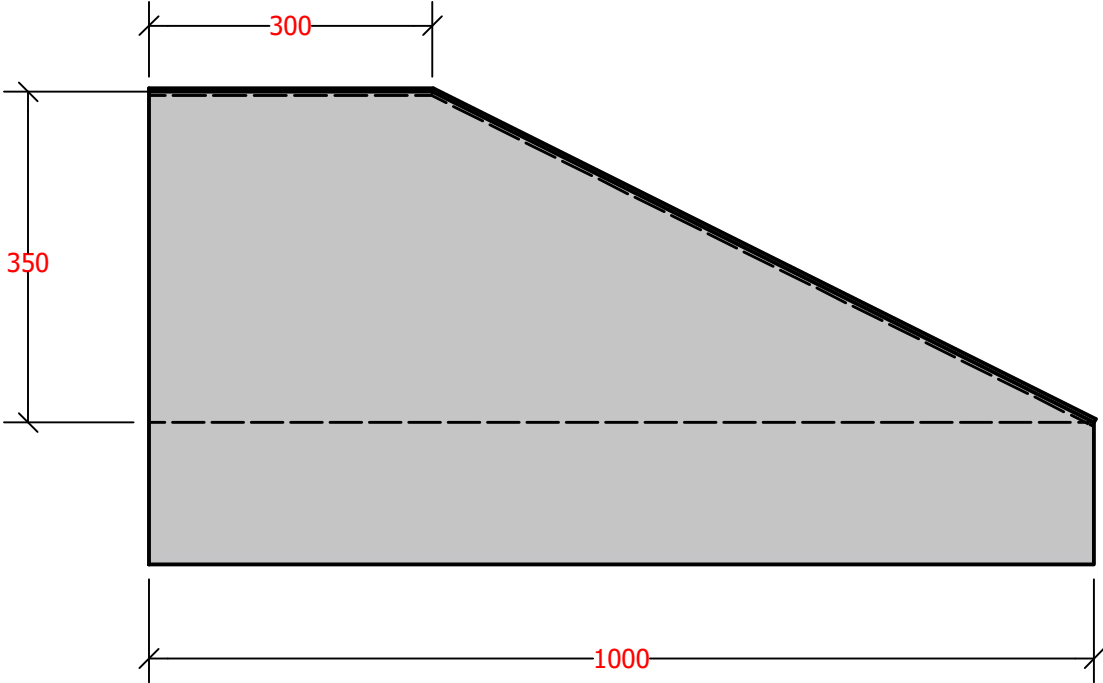
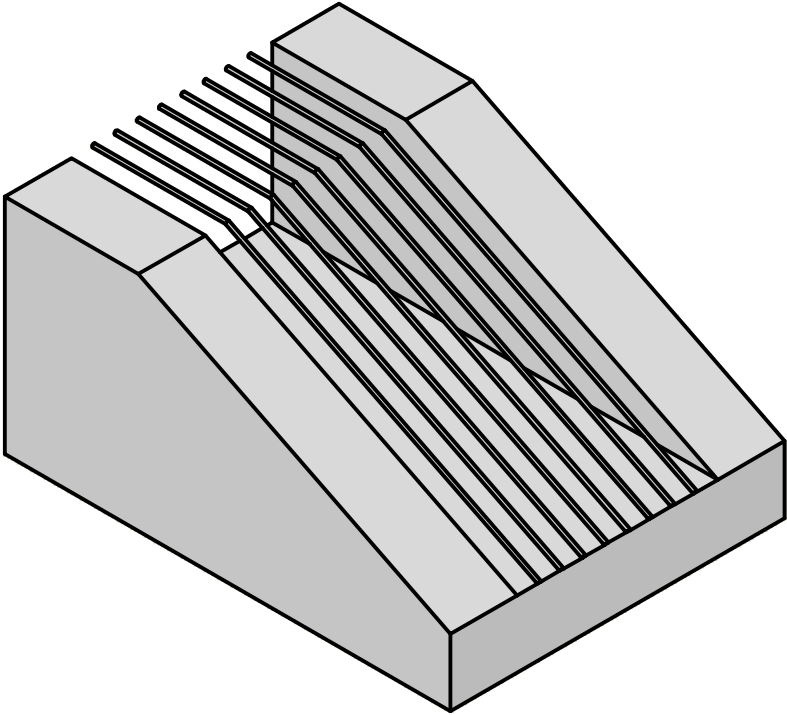

poids fond : 0T450

VISA "BON POUR ACCORD"
AVANT MISE EN FABRICATION

N° COMMANDE

CLIENT:	EUROVIA	CHANTIER: JARDIN DE L'ARS -33- BORDEAUX
BETON TYPE: BPS C30/37 XS2 D10	CREE PAR B. NEAU	VERIFIER PAR:
ENROBAGE: 30mm	DATES: 30/06/2022	REV: 1
DIMENTION +- 20mm	Manutention : ARTEON 5T (qté: 4)	